

**GEORGIA
DEPARTMENT OF
TRANSPORTATION**
District Five Location Surveys

SURVEY CONTROL PACKET

VERSION NO: 1 **DATE:** November 17, 2015

LOCATION JOB NUMBER: N/A

PROJECT NUMBER: 0013549-PE

P.I. NUMBER: 0013549

DESCRIPTION: SR 21 at CS 705/Parkside Blvd. in Port Wentworth

NOTE: Pedestrian bridge project

HORIZONTAL DATUM= NAD83(2011)

VERTICAL DATUM= NAVD88

UNITS OF MEASURE = FEET

LENGTH: 0.4 mile

COUNTY: Chatham

OFFICE OF DESIGN POLICY & SUPPORT
Statewide Location Bureau
3993 Aviation Circle, Atlanta, Ga. 30336
Phone: 404-699-4472
DISTRICT 5 LOCATION SURVEYS
SURVEY CONTROL

SLB JOB NUMBER: N/A

PROJECT NUMBER: 0013549-PE

PL. NUMBER: 0013549

LENGTH: 0.4 Mile

DATE: November 17, 2015

COUNTY: Chatham

DESCRIPTION: SR21 at CS 705/Parkside Blvd in Port Wentworth, per PSR.

NOTE: Pedestrian Bridge project; control was set in area of Rice Mill Road.

ZONE: SPC GEORGIA EAST

HORIZONTAL DATUM: NAD83(2011)

VERTICAL DATUM: NAVD88

UNIT OF MEASUREMENT: US SURVEY FEET

MEAN SEA LEVEL SCALE FACTOR= 1.00000227294

**Note: Deltas 901 and 902 were set, coordinated and elevated by District 5 Location Surveys.
The Survey Control Package was compiled by the Statewide Location Bureau.**

<u>PT#</u>	<u>NORTH</u>	<u>EAST</u>	<u>ELEV.</u>	<u>DESC</u>
901	809,223.768	956,180.872	16.749	D 901
902	809,684.664	956,348.896	17.487	D 902

D 901 is a 3/8" diameter iron pin with yellow GDOT cap, recessed 4 inches below ground. To reach from INT. of I-95 and SR21, travel north on State Route 21 for 2.15 miles to the station on the left as shown below. Described as being located 7.5 feet west of edge of pavement, 33.2 feet S.E. of Power Pole, and 29.6 feet NNE of the south end of a concrete pipe, which runs under Rice Mill Road.

PI# 0013549
Chatham County
SR21 at Rice Mill Road
DISTRICT 5 LOCATION SURVEYS

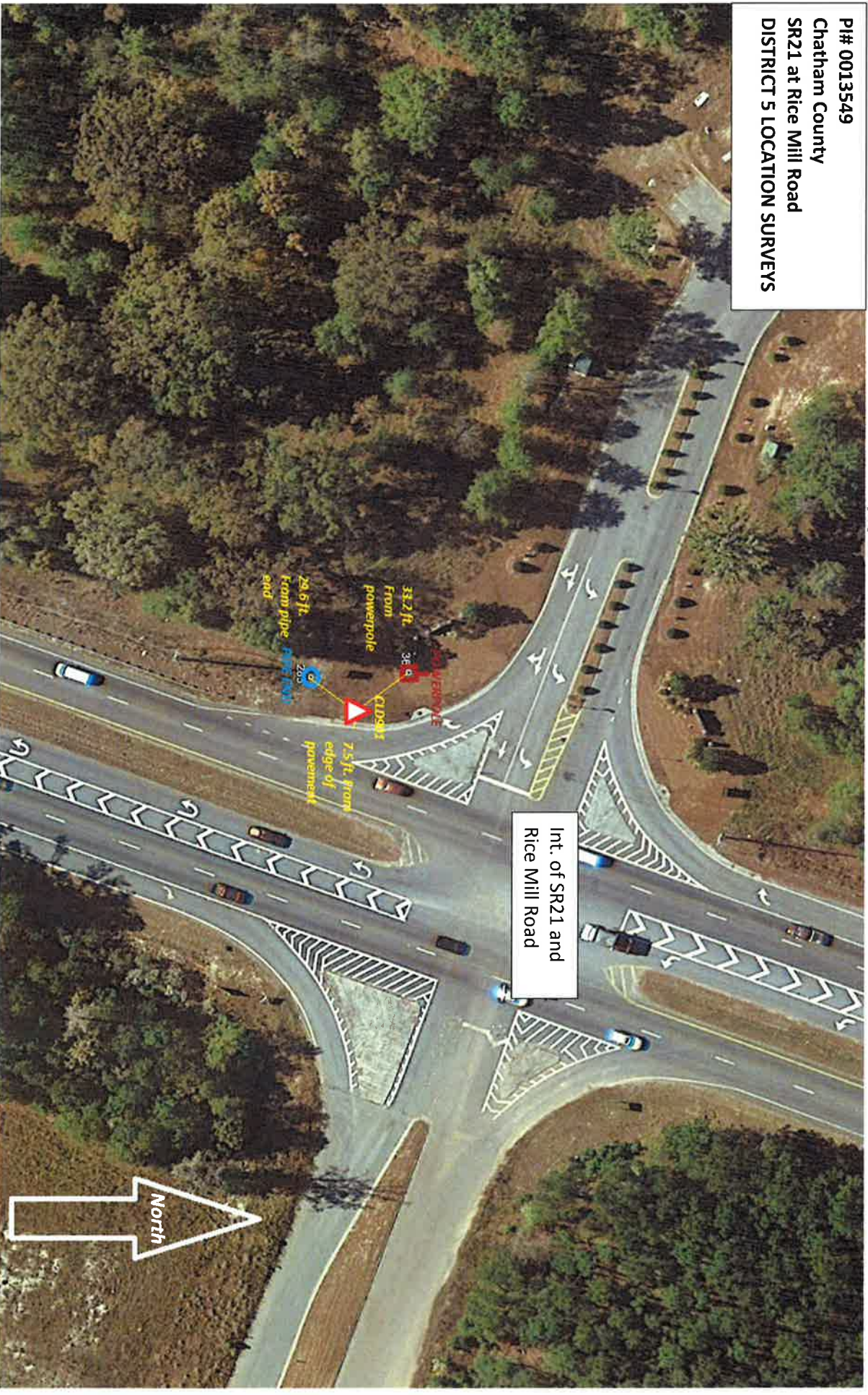

D 902 is a 3/8" diameter iron pin with yellow GDOT cap, recessed 4 inches below ground.
To reach from INT. of I-95 and SR21, travel north on State Route 21 for 2.25 miles to the station on the left as shown below.
Described as being 3.1 feet west of edge of pavement, 195.8 feet north of end of pipe, and 387 feet north of center of Rice Mill Road.

PI# 0013549
Chatham County
SR21 at Rice Mill Road
DISTRICT 5 LOCATION SURVEYS

